

GRADE:- SM 3

REV. NO.	REVISION	INITIAL	DATE
UNLESS SPECIFIED THE GENERAL TOLERANCE FOR ALL MANUFACTURING ITEM WILL CONFORM TO IS 2012			
MACHINING SYMBOLS			
✓	UNMACHINED SURFACE	5-80/16	SURFACE ROUGHNESS (ARITHMETIC MEAN) 0.001mm
✓	ROUGH MACHINING	8-25/16	
✓	MACHINED SURFACE	16-8/16	
✓	FINE FINISH (GRIND)	0.25-1.6/16	
✓	SUPER FINE FINISH (GRIND)	0-0.25/16	
FIG. NO. PART NO. DESCRIPTION			
CARBON BRUSH FOR TECO GEN. FITTED ON CAGE MOTOR			
URANIUM CORPORATION OF INDIA LTD. A GOVT. OF INDIA ENTERPRISE JADUGUDA MINES			
DRN		MATERIAL	
END		WT REMARKS	
APPO		DIMENSIONS in mm.	
SCALE 2:1		DT. SIGNATURE	
DRG. NO.: D5E/197		PROG	

URANIUM CORPORATION OF INDIA LTD.
(A GOVT. OF INDIA ENTERPRISE)
JADUGUDA MINES

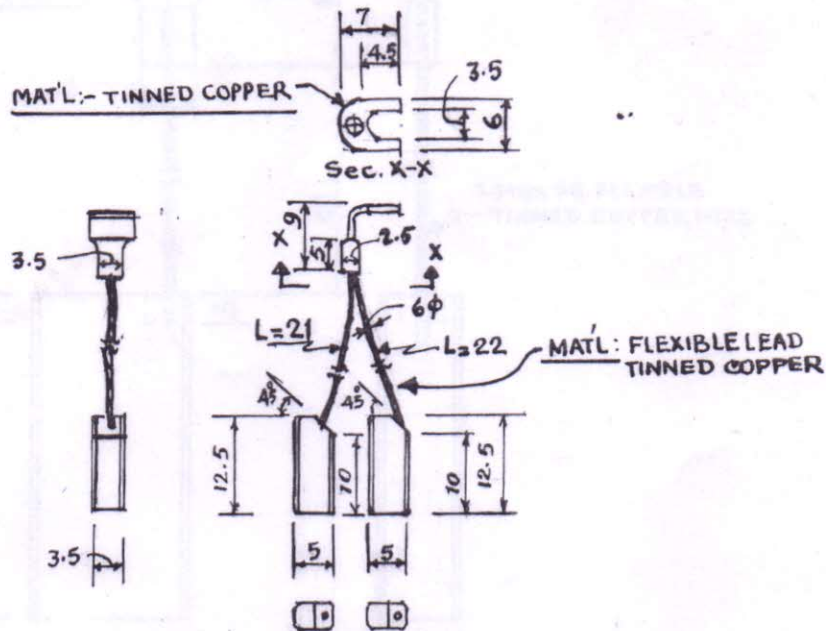

DIMENSIONS IN mm

MAT'L: ELECTRO GRAPHITE
GRADE: EG-259

DRN	<i>[Signature]</i>	CARBON BRUSH FOR Techo Meter Generator Type:- TDP FOR ASEA WINDER (CAGE ON GEARBOX)	APPD. <i>[Signature]</i> 5.7.83.
CHD	<i>[Signature]</i> 5/7/83		DATE 1.7.83
SCALE:- 1:1			DRG.NO. D5E/ 114 A

URANIUM CORPORATION OF INDIA LTD.
(A GOVT. OF INDIA ENTERPRISE)
JADUGUDA MINES

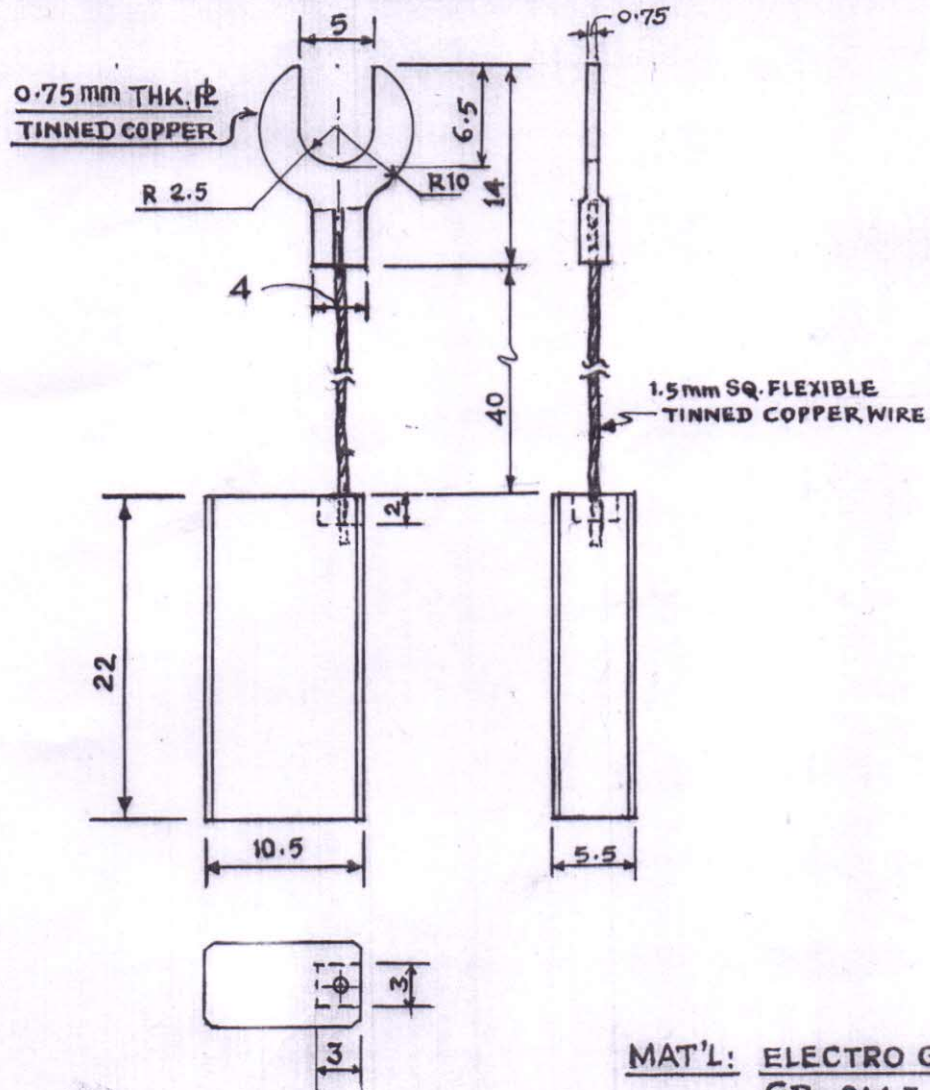

MAT'L: ELECTRO GRAPHITE
GR. SM3

DIMENSIONS IN mm

DRN <i>[Signature]</i>	CARBON BRUSH FOR TECO GENERATOR SIZE BD 25 10 B (ON SKIP MOTOR)	APPD. <i>[Signature]</i> 5.7.83
CHD <i>[Signature]</i> 5/7/83.		DATE 2.7.83
SCALE 2:1 (DOUBLE SIZE)		DRG. NO. D5 E/115 A

UCIL
MINES

URANIUM CORPORATION OF INDIA LTD
JADUGUDA MINES

DRG. NO. E/43 (A)

DATE 30.3.1972

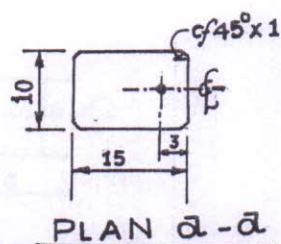
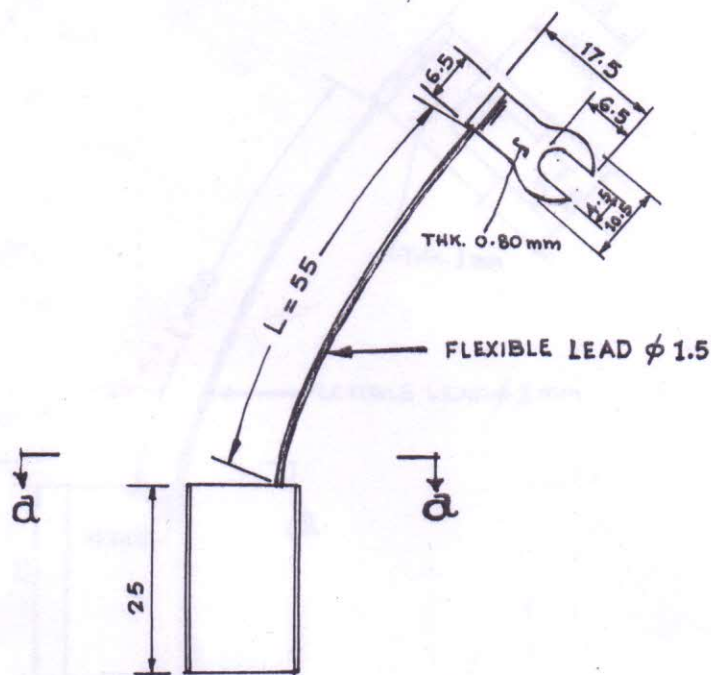

DIMENSIONS IN mm

Grade:- EG 34D

DRAWN

CHECKED

TRACED

SCALE 1:1

CARBON BRUSH
TYPE EL
1-33
FOR CONSTANT VOLTAGE
GENERATOR, TYPE-LD8
(M.G. SET NO.1 SKIP WINDER)

MINES SUPDT.

ASST. SUPDT. ELECT.

DATE 30.3.1972

DRG. NO. E/43 (A)

UCIL
MINES

URANIUM CORPORATION OF INDIA LTD.
JADUGUDA MINES

DRG. NO. E/43 (B)

DATE 30.3.1972

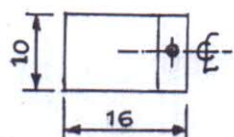
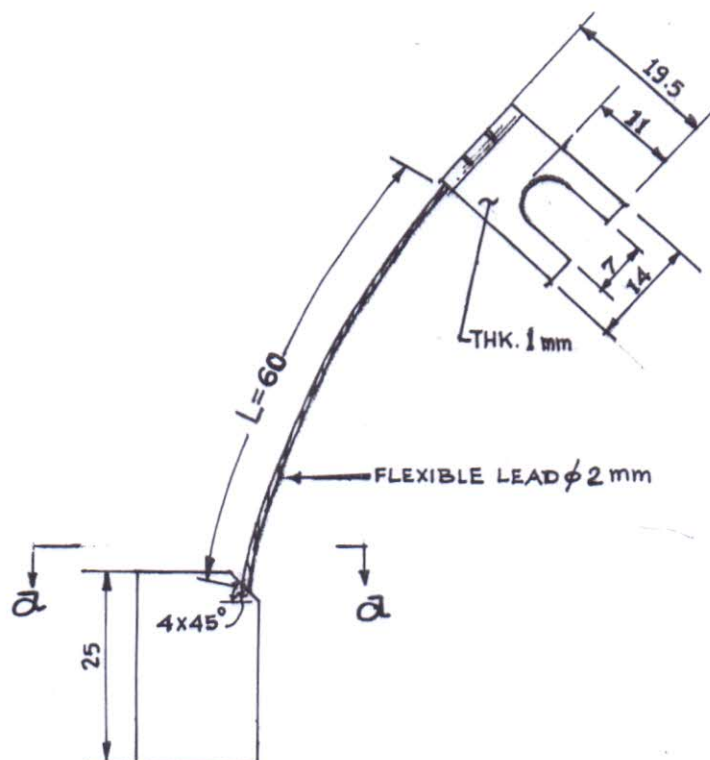

PLAN a-a

DIMENSIONS IN mm.

Grade:- EG 34D

DRAWN

CHECKED

TRACED

SCALE 1:1

CARBON BRUSH

TYPE:- EG
34D

FOR CONSTANT VOLTAGE

GENERATOR, TYPE:- LAT 112

(M.G. SET NO. 2 SKIP WINDER)

MINES SUPDT.

ASSTT. SUPDT. (ELECT.)

DATE 30.3.1972

DRG. NO. E/43 (B)



MATERIAL - COPPER GRAPHITE

GRADE - CM5H

MATERIAL- COPPER GRAPHITE

MATERIAL - COPPER GRAPHITE

CARBON BRUSH OF SYNCHRO MOTOR

Fig. 1 D'ÉLÉ/CCG (WINDING REGULATOR)

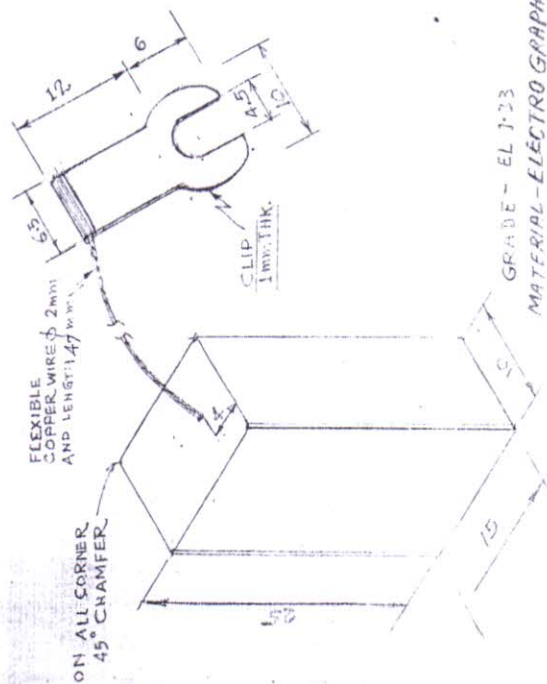

GRADE - EL J.23

MATERIAL-ELECTRO GRAPHITE

TYPE LD 13

CARBON BRUSH (E T C EY CITE)

000000

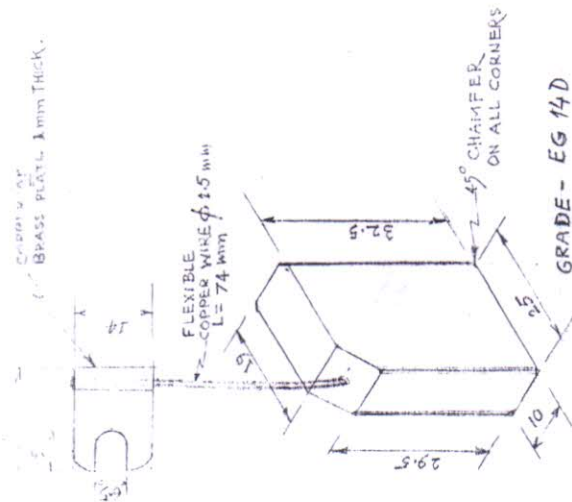

GRADE- EG 14D

MATERIAL - ELECTRO GRAPHITE

TYPE LDI1

CARBON BRUSH FOR COMPRESSOR
TYPE EDII
FIG 3B E/Q9C EXCITER

Fig. 3. $E/a_0 c$ EXCITER

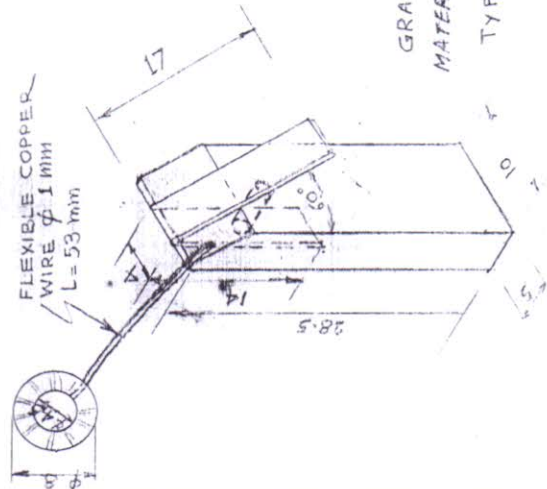

GRADE - SM3

MATERIAL-COPPER GRAPHITE

TYPE LVA6 & LVA6-1

CARBON BRUSH CO. 1000 TAYLOR ST.
CHICAGO, ILL. 60606 (CHICAGO 2-8826)

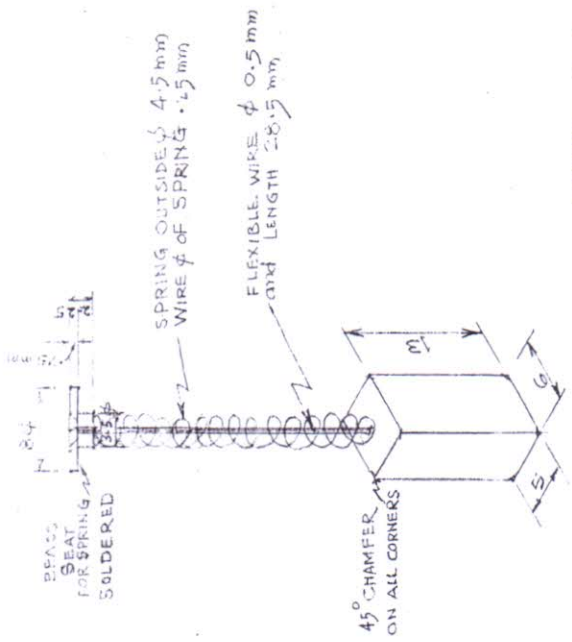

GRADE - SM 3

MATERIAL -- ELECTRO GRAPHITE

TYPE TAC-4

CARBON BRUSH OF SELSYN TRANSMITTER

FIG. 10. $D_0E/09C$ in (Winding Regulator)

DIMENSIONS IN mm

URANIUM CORPORATION OF INDIA LTD.
(A GOVT. OF INDIA ENTERPRISE)

JADUGUDA MINE

CARBON DIOXIDE

MINE SUPPLY

DR. SUPPL. (NAME) _____

ASSISTANT ELECT. ENGR.

10.2.25

DATE: